



# HiPace<sup>®</sup> 300 with TC 110, DN 100 CF-F



Similar Image

## HiPace® 300 with TC 110, DN 100 CF-F

- Rugged, powerful turbopump with a pumping speed of up to 260 l/s for N<sub>2</sub>
- Integrated TC 110 drive electronics
- Ideal for UHV applications
- For installation in any orientation
- Extensive accessories expand the range of applications

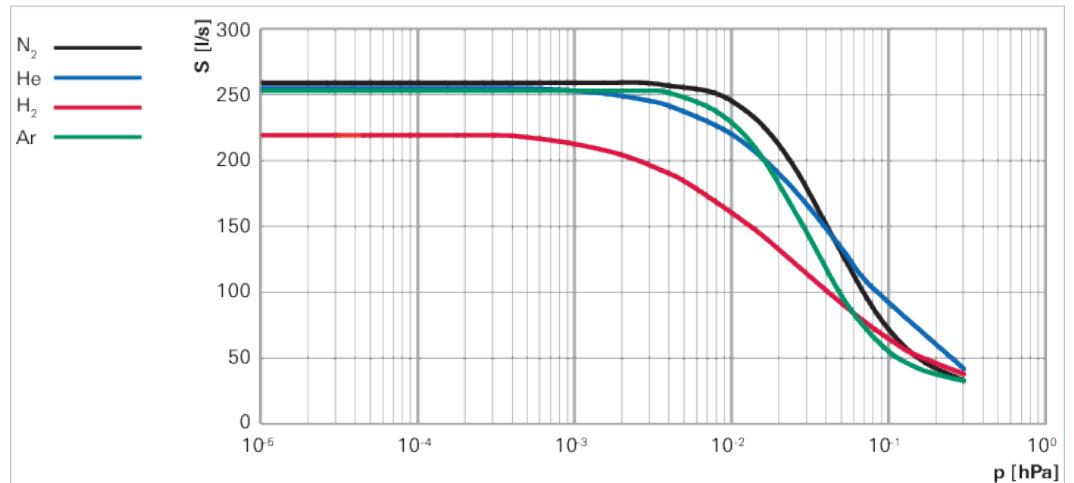

### Dimensions

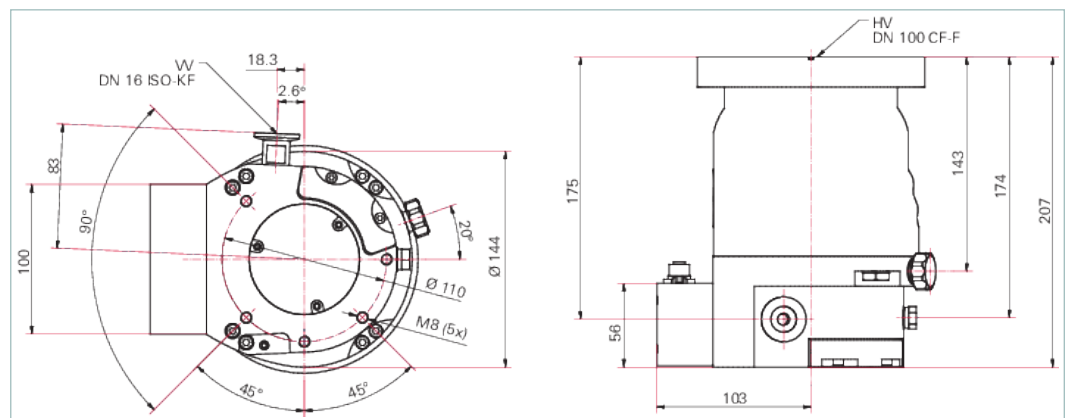

Technical Data	HiPace® 300 with TC 110, DN 100 CF-F
Bearing	Hybrid
Compression ratio for Ar	$> 1 \cdot 10^{11}$
Compression ratio for H <sub>2</sub>	$9 \cdot 10^5$
Compression ratio for He	$> 1 \cdot 10^8$
Compression ratio for N <sub>2</sub>	$> 1 \cdot 10^{11}$
Cooling method, optional	Water
Cooling method, standard	Air
Cooling water consumption	50 l/h
Cooling water temperature	15-35 °C   59-95 °F   288-308 K
Electronic drive unit	with TC 110
Flange (in)	DN 100 CF-F
Flange (out)	DN 16 ISO-KF/G ¼"
Fore-vacuum max. for N <sub>2</sub>	15 hPa   11.25 Torr   15 mbar
Gas throughput at full rotational speed for Ar	2 hPa-l/s

Technical Data	HiPace® 300 with TC 110, DN 100 CF-F
Gas throughput at full rotational speed for H <sub>2</sub>	> 14 hPa·l/s
Gas throughput at full rotational speed for He	8 hPa·l/s
Gas throughput at full rotational speed for N <sub>2</sub>	5 hPa·l/s
Interfaces	RS-485, Remote
Mounting orientation	in any orientation
Operating voltage: V DC	24 (5) V DC
Permissible magnetic field max.	5.5 mT
Protection category	IP54
Pumping speed for Ar	255 l/s
Pumping speed for H <sub>2</sub>	220 l/s
Pumping speed for He	255 l/s
Pumping speed for N <sub>2</sub>	260 l/s
Pumping speed range	300 l/s
Rotation speed ± 2 %	60,000 rpm   60,000 min <sup>-1</sup>
Run-up time	3.5 min
Sound pressure level	≤ 50 dB(A)
Ultimate pressure according to PNEUROP	< 5 · 10 <sup>-10</sup> hPa   < 3.75 · 10 <sup>-10</sup> Torr   < 5 · 10 <sup>-10</sup> mbar
Venting connection	G 1/8"
Weight	8.2 kg   18.08 lb

Order number	
HiPace® 300	PM P03 991

<b>Accessories</b>	
<b>Adapters/connections TC 110</b>	
Enclosure for plug, spraywater-protected, 15-pole, D-sub	<b>P 0998 016</b>
Mains power plug for TC 110/120 and mating plug for E74 interface, straight	<b>P 4723 110</b>
Mains power plug angled for TC 110/120 and mating plug for interface E74	<b>P 4723 111</b>
TCS 11, adapter for TC 110/120 with RS-485 interface	<b>PM 061 636 -U</b>
TCS 12, adapter for TC 110/120 with interface RS-485, 4 accessory ports and coupling set	<b>PM 061 638 -U</b>
TCS 13, adapter for TC 110/120 with interface RS-485, 2 accessory ports and coupling set	<b>PM 061 856 -U</b>
<b>Mains cables</b>	
Mains cable 230 V AC, CEE 7/7 to C13, 3 m	<b>P 4564 309 ZA</b>
Mains cable 115 V AC, NEMA 5-15 to C13, 3 m	<b>P 4564 309 ZE</b>
Mains cable 208 V AC, NEMA 6-15 to C13, 3 m	<b>P 4564 309 ZF</b>
<b>RS-485 accessories</b>	
Y-Connector M12 to RS-485	<b>P 4723 010</b>
USB converter to RS-485 interface	<b>PM 061 207 -T</b>
Connector M12 to RS-485	<b>PM 061 270 -X</b>
Termination resistor for RS-485	<b>PT 348 105 -T</b>
Power separator for RS-485	<b>PT 348 132 -T</b>
<b>Vibration damper</b>	
Vibration damper for HiPace 300/400, DN 100 CF-F	<b>PM 006 488 -X</b>
<b>Splinter shield for Pfeiffer Vacuum turbo pumps</b>	
Splinter shield for turbopumps, DN 100 CF-F	<b>PM 016 315</b>
<b>Protection screen for Pfeiffer Vacuum turbo pumps</b>	
Protection screen for DN 100 CF-F	<b>PM 016 336</b>
<b>Water cooling</b>	
Water cooling for HiPace 300 with push-in fitting 8 mm	<b>PM 016 624 -T</b>
Water cooling for HiPace 300 with 6 mm push-in fitting	<b>PM 016 636 -T</b>
Water cooling for HiPace 300 with tube fitting 1/4"	<b>PM 016 637 -T</b>
Water cooling for HiPace 300 with hose nozzle, 9.5 mm	<b>PM 016 655 -T</b>
<b>Set of hexagon screws for trough hole</b>	
Set of hexagon screws for through hole, DN 100 CF-F	<b>PM 016 690 -T</b>
<b>Set of stud screws for trough hole</b>	
Set of stud screws for through hole, DN 100 CF-F	<b>PM 016 734 -T</b>
<b>Venting accessory with small flange, G 1/8", hoses, air drier</b>	
Screw-on flange, DN 16 ISO-KF, G 1/8"	<b>PM 016 780 -T</b>
Push-in fitting for 6 mm hose, G 1/8"	<b>PM 016 781 -T</b>
Push-in fitting for 8 mm hose, G 1/8"	<b>PM 016 782 -T</b>
Hose nozzle for 9 mm hose, G 1/8"	<b>PM 016 783 -T</b>
Banjo fitting	<b>PM 016 787 -T</b>
Screw-in flange, DN 10 ISO-KF, G 1/8"	<b>PM 033 737 -T</b>
Banjo fitting, small	<b>PM 143 877 -T</b>
TTV 001, dryer for venting turbopumps	<b>PM Z00 121</b>
<b>Set of stud screws for tapped hole</b>	
Set of stud screws for tapped hole, DN 100 CF-F	<b>PM 016 866 -T</b>

<b>Accessories</b>	
<b>Control and display units</b>	
HPU 001, Handheld Programming Unit	PM 051 510 -T
DCU 002, Display Control Unit	PM 061 348 -T
<b>Accessory for DCU/HPU</b>	
Accessories package for HPU 001/PC	PM 061 005 -T
<b>Accessories RS-485</b>	
Interface cable, M12 m straight/M12 m straight, 3 m	PM 061 283 -T
<b>Accessories Diaphragm pumps</b>	
TPS 180, mains pack for wall/standard rail fitting	PM 061 341 -T
<b>Mains pack 19" rack module 3HU with front panel</b>	
TPS 181, mains pack 19" rack module 3HU	PM 061 345 -T
<b>Connection cables</b>	
Connection cable with RS-485 interface for TC 110/120 to power supply	PM 061 350 -T
Connection cable with RS-485 interface and 2 accessory ports for TC110/120 to power supply	PM 061 351 -T
Connection cable with RS-485 interface and 3 accessory ports for TC 110/120 to power supply	PM 061 512 -T
Connection cable for HiPace with TC 110/120	PM 061 543 -T
Connection cable incl. 2 accessory ports for TC 110/120 to power supply	PM 061 552 -T
<b>Heating suitable for TC 110 and TC 400</b>	
Heating jacket for HiPace 300 with TC 110, 230 V AC, safety plug	PM 061 363 -T
Heating jacket for HiPace 300 with TC 110, 208 V AC, UL plug	PM 061 364 -T
Heating jacket for HiPace 300 with TC 110, 115 V AC, UL plug	PM 061 365 -T
<b>Relay boxes suitable for TC 110, TC 400 and TCP 350</b>	
Relay box for backing pump, single phase 20 A for TC 110/120 and TCP 350, M8 plug	PM 061 373 -T
<b>Wall rail fitting</b>	
Wall rail fitting for TPS 110/180/310/400	PM 061 392 -T
<b>Front panel kit as spare part</b>	
Front panel kit for TPS 181	PM 061 394 -T
<b>Adapter and control cables</b>	
Control cable for valve	PM 061 687 -T
HiPace - ACP connection cable	PM 071 142 -X
<b>Extension cables</b>	
Extension cable M8 on M8	PM 061 783 -T
<b>Interface cables</b>	
Interface cable, M12 m straight/ M12 m angled 0.7 m	PM 061 791 -T
<b>Shielded relay boxes suitable for TC 110/TC 400 with PB, TC 1200 and TM 700</b>	
Relay box, shielded, for backing pumps, 1-phase 7A for TC 110/120 and TCP 350, plug M8	PM 071 282 -X
<b>DCU with integrated power supply</b>	
DCU 180, Display control unit incl. power supply	PM C01 821
<b>Fore-vacuum safety valves</b>	
TVV 001 fore-vacuum safety valve, 230 V AC	PM Z01 205
TVV 001 fore-vacuum safety valve, 115 V AC	PM Z01 206
<b>Venting valve (normally closed)</b>	
Venting valve, shielded, 24 V DC, G 1/8", for connection to TC 110/120	PM Z01 290

<b>Accessories</b>	
<b>Air coolings (unshielded)</b>	
Air cooling for HiPace 300/450 with TC 110/120	<b>PM Z01 301</b>
<b>Air coolings 115/230 V</b>	
Air cooling for HiPace 300/450, 115 V	<b>PM Z01 308</b>
Air cooling for HiPace 300/450, 230 V	<b>PM Z01 309</b>
<b>Sealing gas valve, shielded (normally closed)</b>	
Sealing gas valve, shielded for HiPace 300 with TC 110/120	<b>PM Z01 311</b>
<b>Sealing gas throttle</b>	
Sealing gas throttle for HiPace 300	<b>PM Z01 317</b>
<b>Power failure venting units (normally open)</b>	
Shielded power failure venting unit, 24 V DC, G 1/8", for connection to TC 110/120	<b>PM Z01 330</b>
<b>Pressure Sensors</b>	
TIC 010, Adapter for two sensors	<b>PT R70 000</b>
RPT 010, Digital Piezo/Pirani Sensor	<b>PT R71 100</b>
IKT 010, Digital Cold Cathode Sensor, low current	<b>PT R72 100</b>
IKT 011, Digital Cold Cathode Sensor, high current	<b>PT R73 100</b>
<b>OFHC Copper (Oxygen Free)</b>	
Copper Gasket, OFHC-copper, DN 100 CF	<b>490DFL100-S10</b>
<b>FKM cut from sheet material</b>	
Elastomer Gasket, FKM, DN 100 CF	<b>402DFL100-S2</b>
<b>FKM with centering lip; heat-molded</b>	
Elastomer Gasket, FKM, DN 100 CF	<b>402DFL100-Z</b>
<b>OFHC Copper (Oxygen Free), Vacuum-annealed</b>	
Copper Gasket, Vacuum-annealed, DN 100 CF	<b>490DFL100-G-S5</b>
<b>OFHC Copper (Oxygen Free), Silver-plated</b>	
Copper Gasket, Silver-plated, DN 100 CF	<b>490DFL100-S-S5</b>
<b>OFHC Copper (Oxygen Free), Silver-plated, Vacuum-annealed</b>	
Copper Gasket, Silver-plated, Vacuum-annealed, DN 100 CF	<b>490DFL100-S-G-S5</b>

## **VACUUM SOLUTIONS FROM A SINGLE SOURCE**

Pfeiffer Vacuum stands for innovative and custom vacuum solutions worldwide, technological perfection, competent advice and reliable service.

## **COMPLETE RANGE OF PRODUCTS**

From a single component to complex systems:

We are the only supplier of vacuum technology that provides a complete product portfolio.

## **COMPETENCE IN THEORY AND PRACTICE**

Benefit from our know-how and our portfolio of training opportunities!

We support you with your plant layout and provide first-class on-site service worldwide.

Are you looking for a  
perfect vacuum solution?  
Please contact us:

**Pfeiffer Vacuum GmbH**  
Headquarters · Germany  
T +49 6441 802-0  
info@pfeiffer-vacuum.de

[www.pfeiffer-vacuum.com](http://www.pfeiffer-vacuum.com)

All data subject to change without prior notice.

**PFEIFFER**  **VACUUM**